

# FTP-V Electro\* Roof Window

**with integrated electrical system, operated by means of a remote control.**

The new FTP-V Electro window is a pivot FTP-V window factory equipped with devices enabling its opening and closing as well as accessories' operating with the use of a remote control. This roof window ensures the highest level of loft space usage comfort since it can be operated from any place in the room and automatically closed in case of rain.



The FTP-V Electro roof window can be installed in any loft room. It is particularly recommended for those rooms where windows are installed at great height, beyond user direct reach.

The servo-motor with the reach of 24 cm makes it possible to open and close the sash. There is a possibility of disconnecting the servo-motor in case of power failure or when the external pane requires washing by turning the handle through 90 degrees. The FTP-V roof window has got a built-in

ZRD rain sensor which automatically initiates the sash closing function when the first rain drops appear. All window functions are operated with the use of one remote control.

The whole integrated window control mechanism (control unit and servo-motor) is contained under an attractive aluminium cover fitted in the frame's lower part.





The FTP-V Electro roof window is factory equipped with a 3-channel control unit with 24V DC power supply and ZC 24 servo-motor. It is also fitted with contacts facilitating the installation of electrically operated internal accessories ARF-E or AJP-E and external roller shutter ARZ-E. These accessories are adjusted to the control unit and operated with the same remote control.

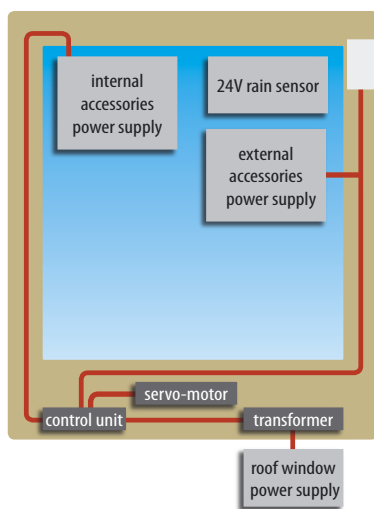
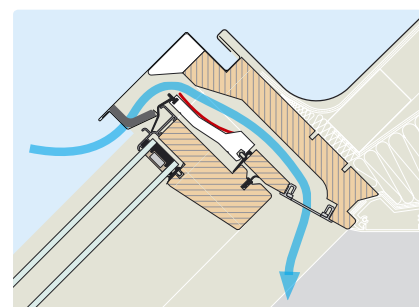

The window can be installed on roofs with pitches 15 to 90 degrees. The FAKRO system allows Electro roof windows installation in conjunction with standard flashings as well as standard internal and external electrically operated accessories.

The Electro roof window installation procedure is very similar to the one applied in case of standard FAKRO roof windows installation. There is no need to fit any additional wiring system as the window power supply voltage is 230 V. All that is required is to connect the wire to the domestic power network or just simply insert plug into a socket.

The FTP-V Electro roof window is manufactured like any other standard FTP-V window. It is equipped with a new, automatic, pressure air inlet V40P, which enables fresh air inflow into the room at an optimum rate.



### FTP-V Electro roof window sizes

external window frame dimensions	66x98	66x118	78x98	78x118	78x140
illumination area [m <sup>2</sup> ]	0,51	0,62	0,62	0,75	0,91
actual glazed surface [m <sup>2</sup> ]	0,38	0,47	0,47	0,59	0,72
window symbol	03	04	05	06	07