

1/2

Original manual User manual

FAKRO[®]

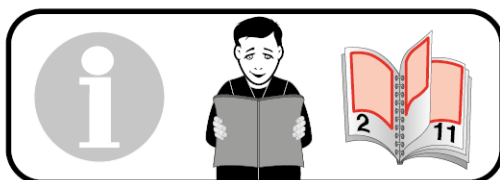

EN

PLEASE NOTE! PLEASE READ THE FOLLOWING USER MANUAL CAREFULLY BEFORE INSTALLING AND OPERATING THE DOOR. KEEP THIS DOCUMENT FOR FUTURE REFERENCE.

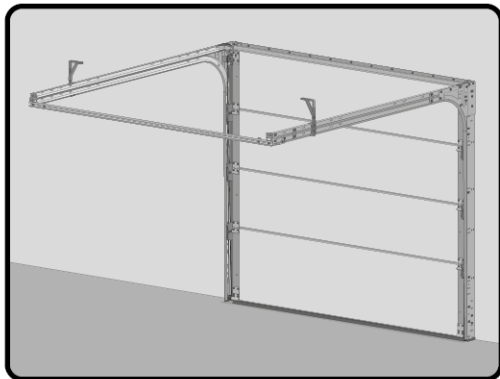
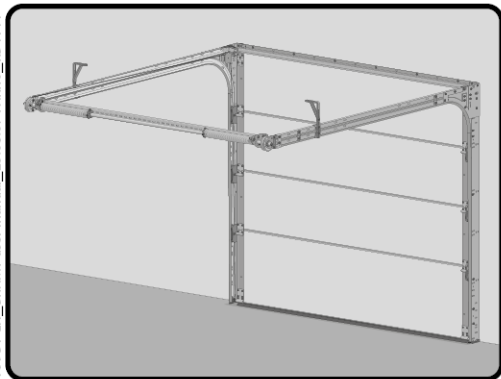
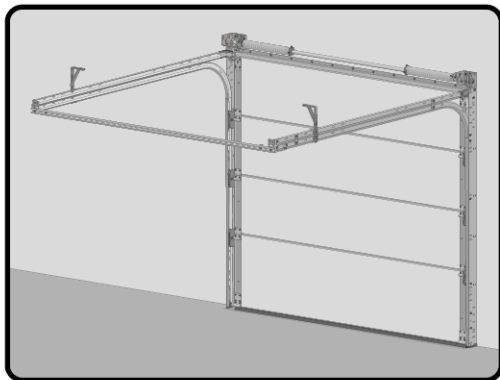
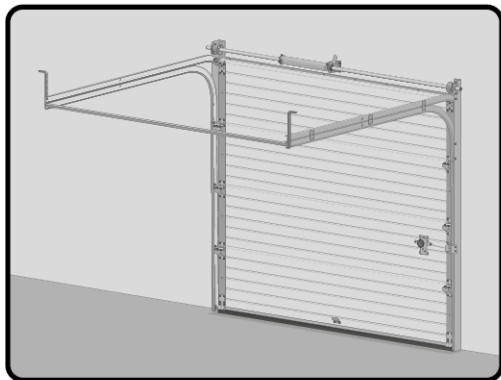



1

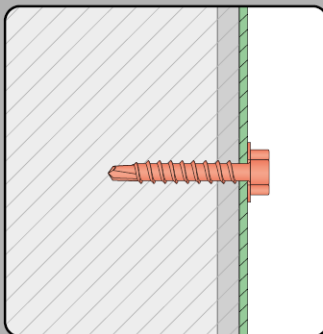
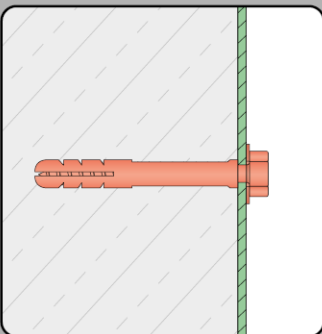
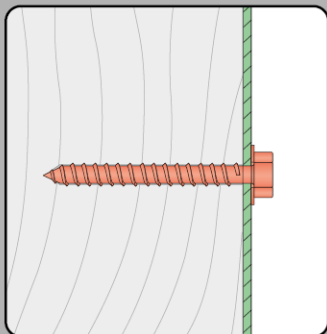
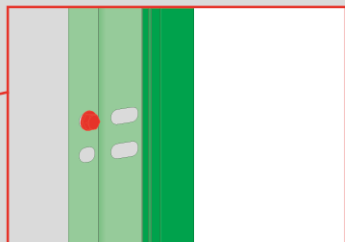
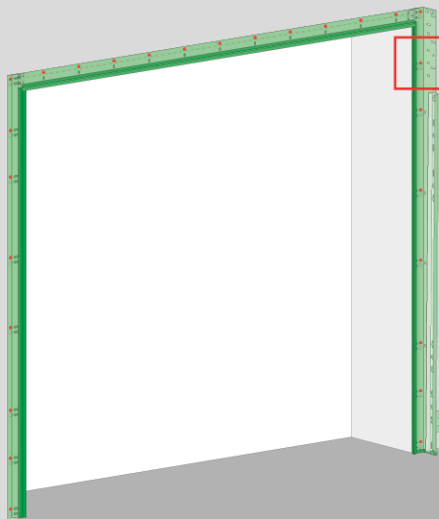

2

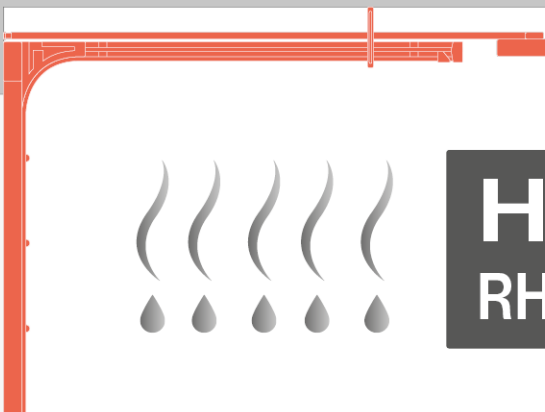

HYGRO
RH MAX 80%

3

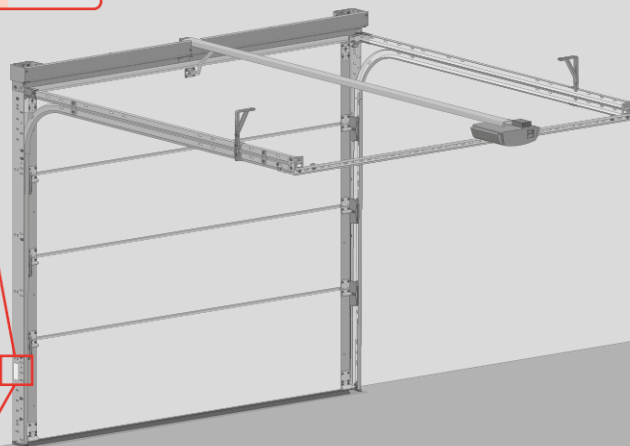
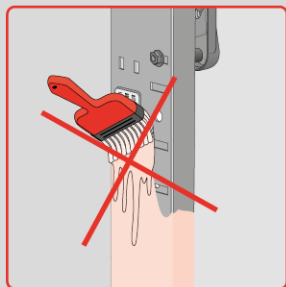

BST STYLE+ X 2500x2125

BRABSBBTMGHR25002125 7471 01

12345 123

FAKRO
www.fakro.com

CE

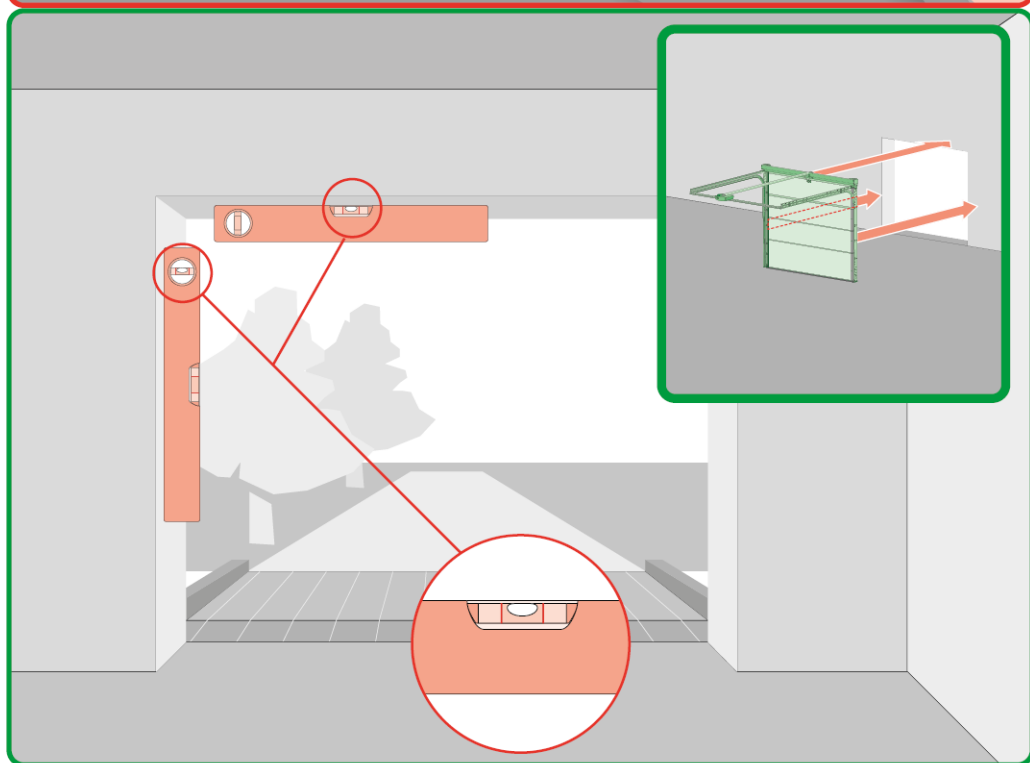
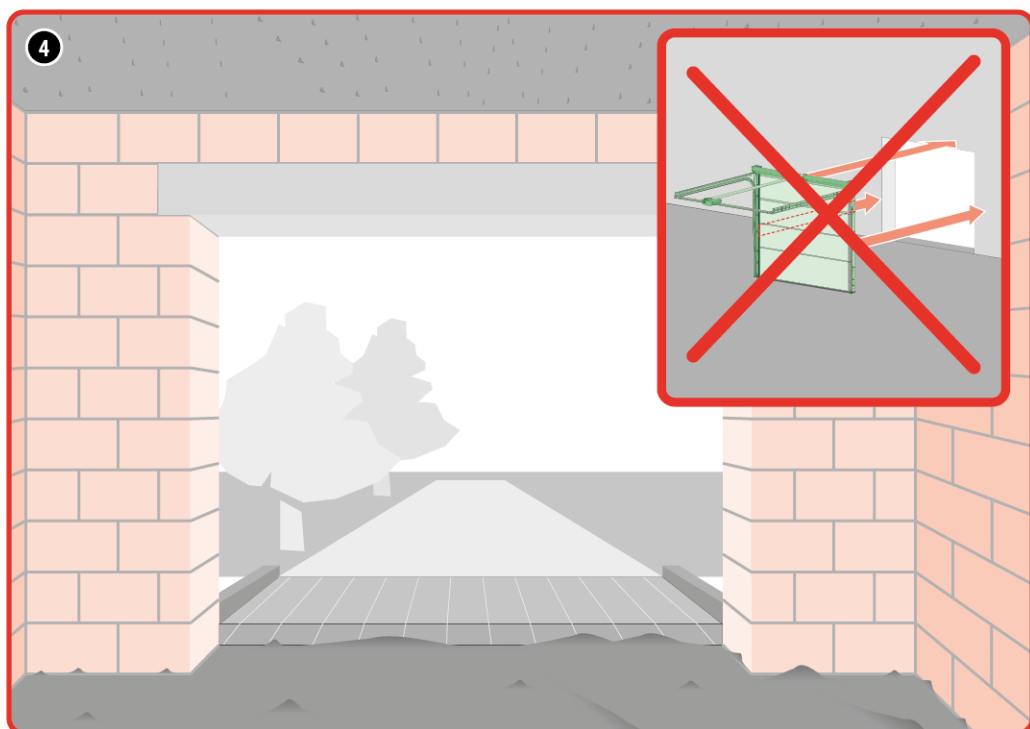

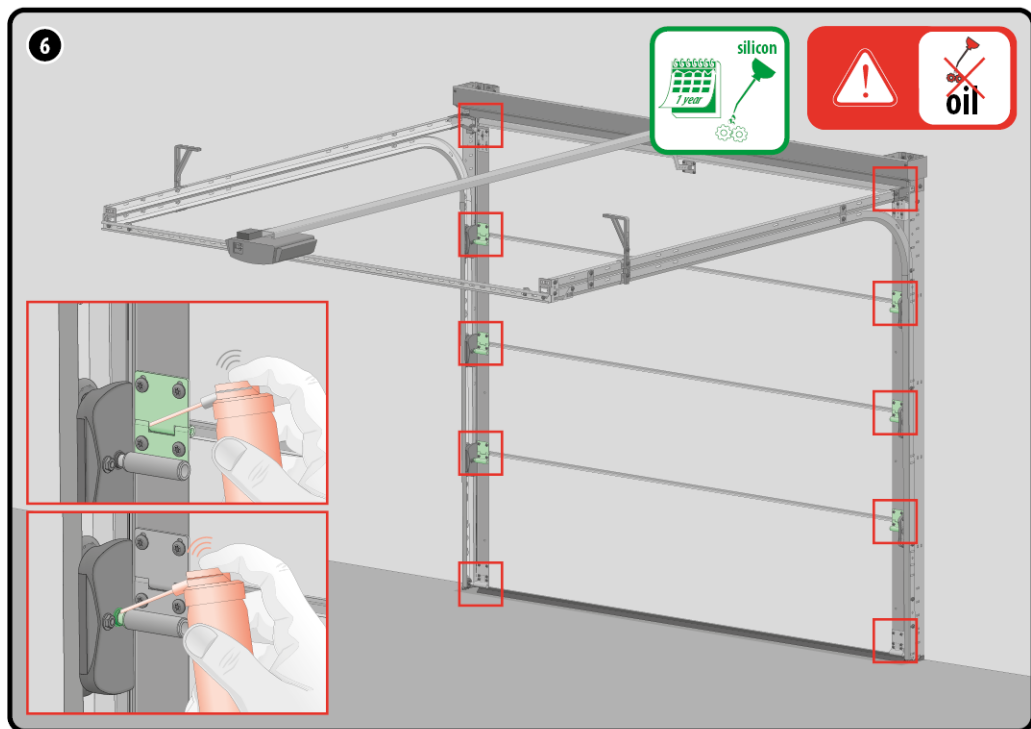
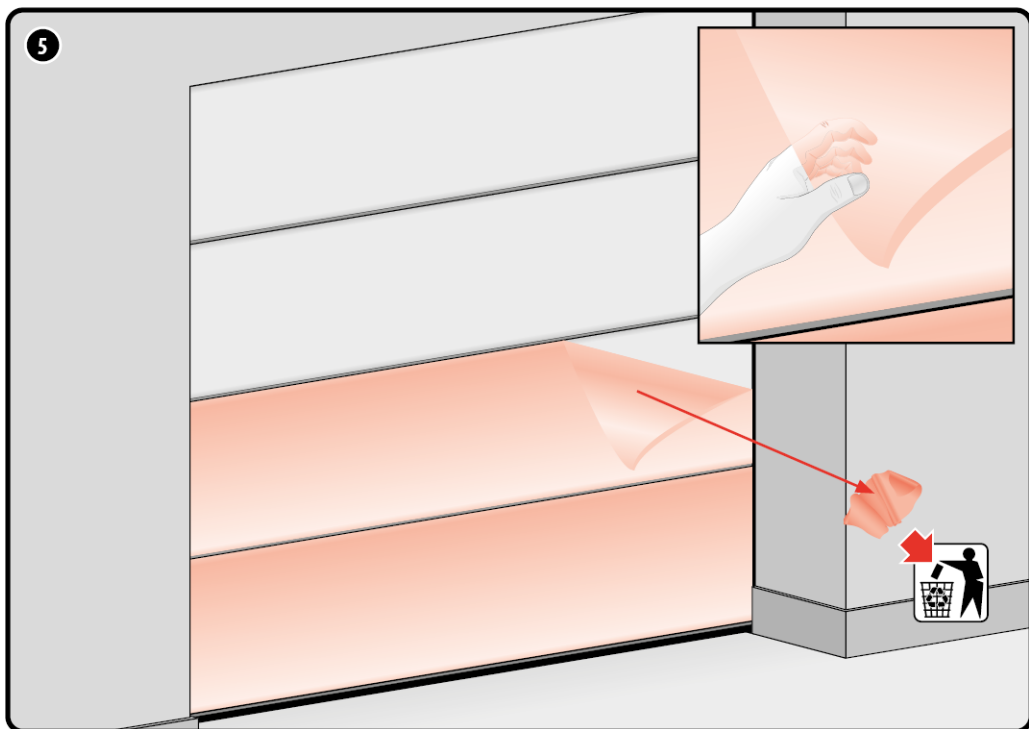

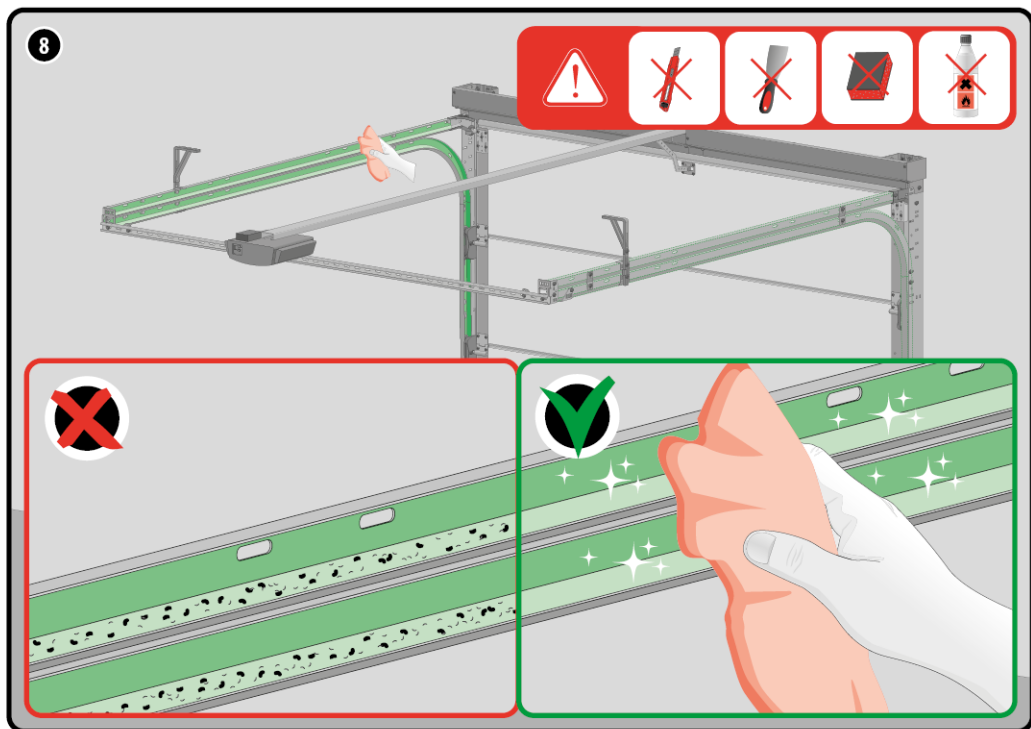
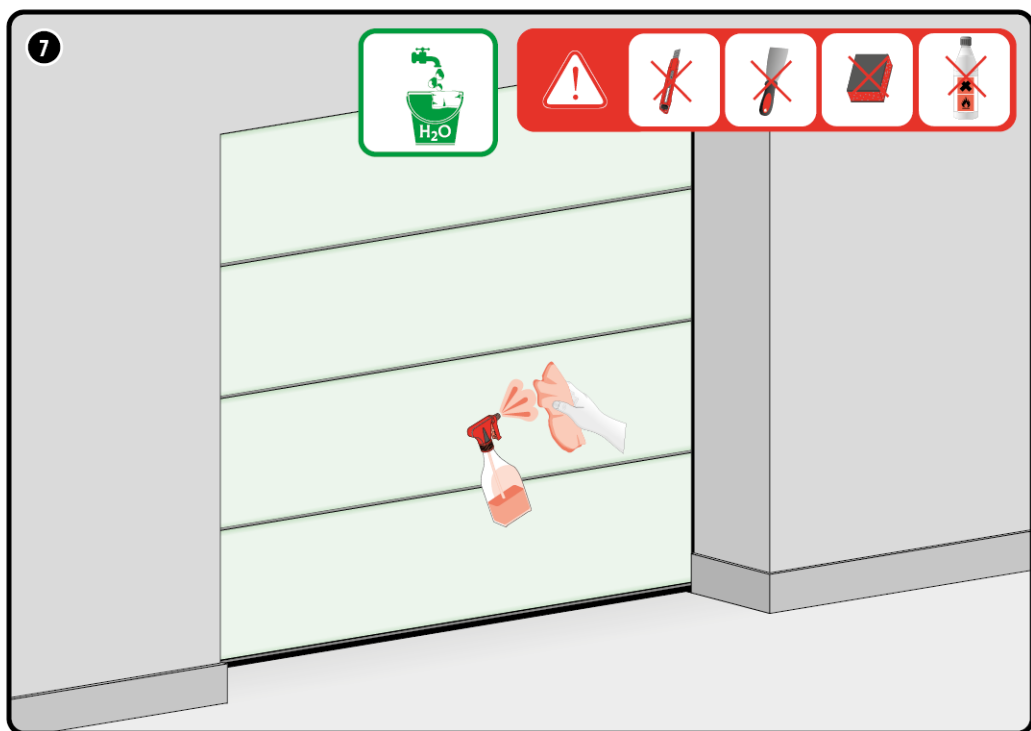

9



10



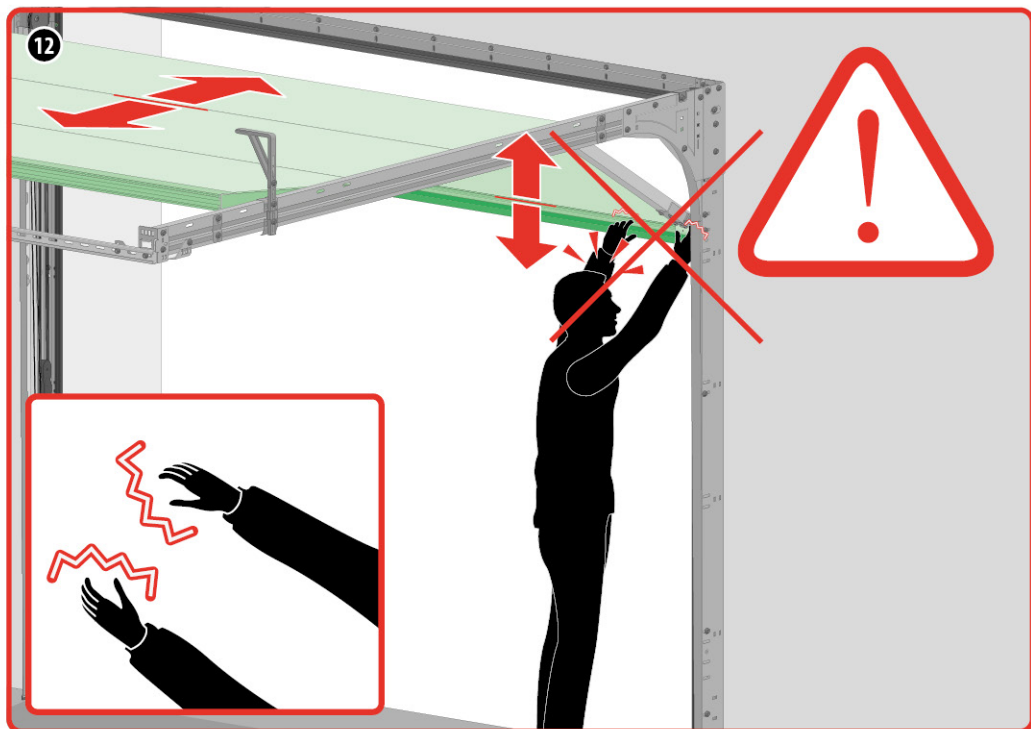
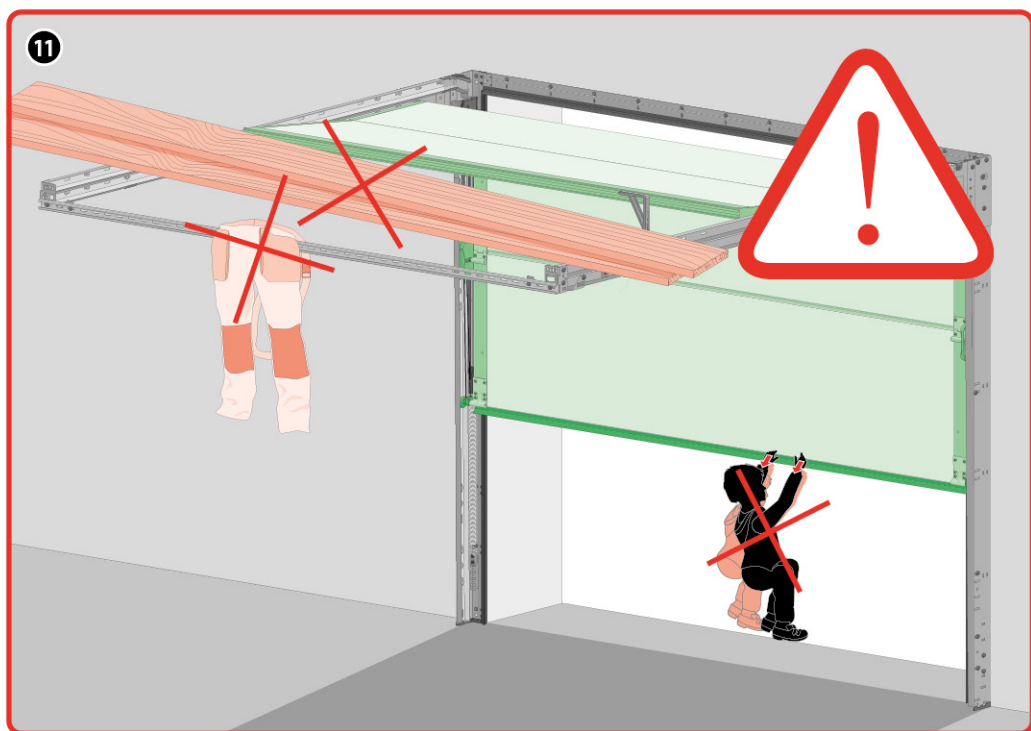

13

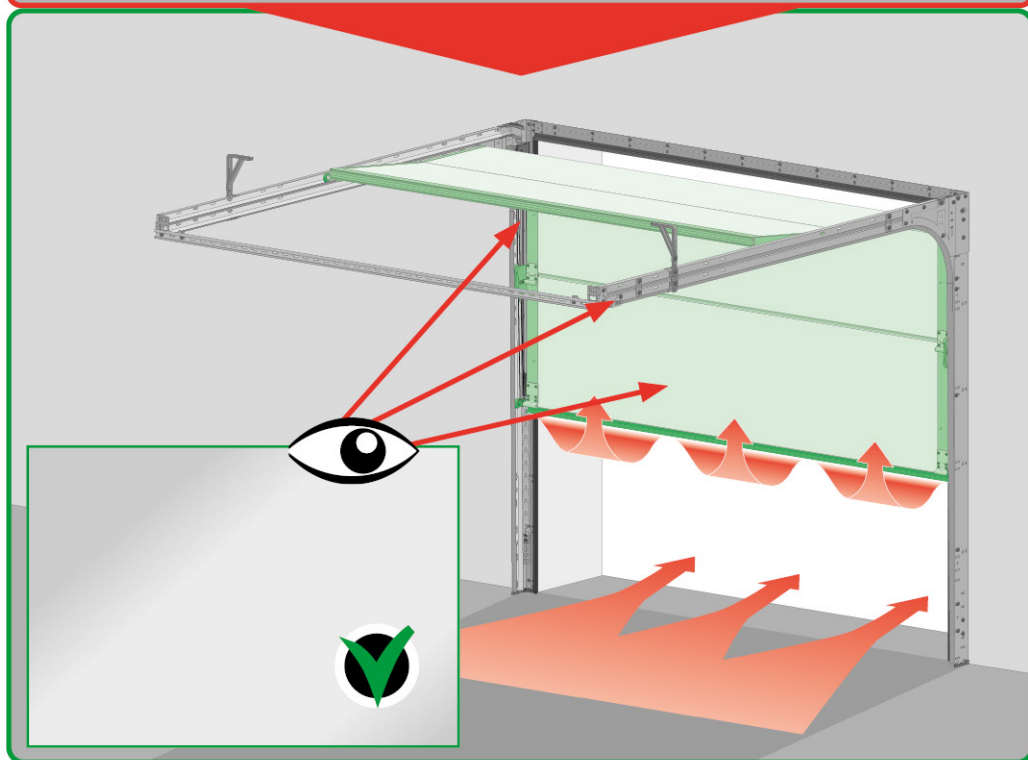
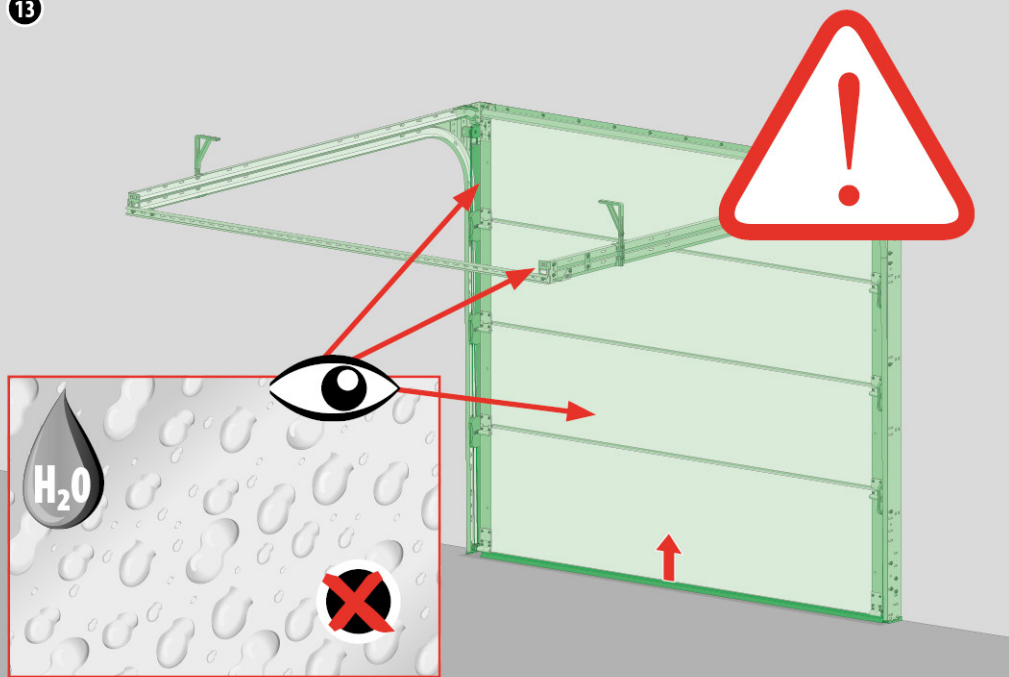

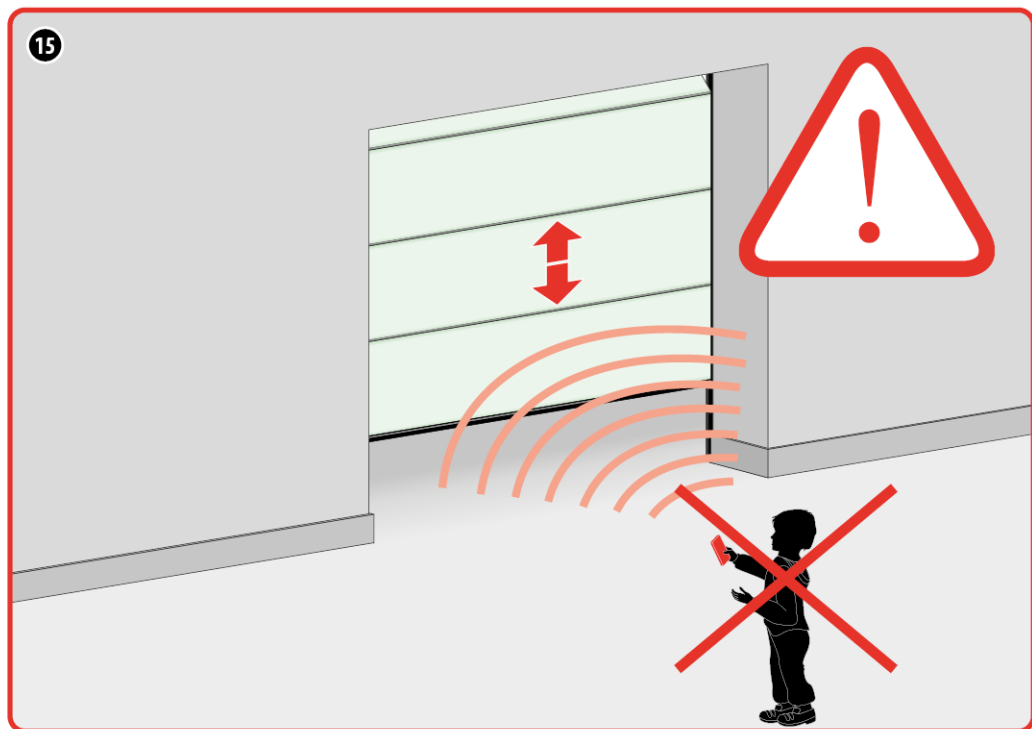
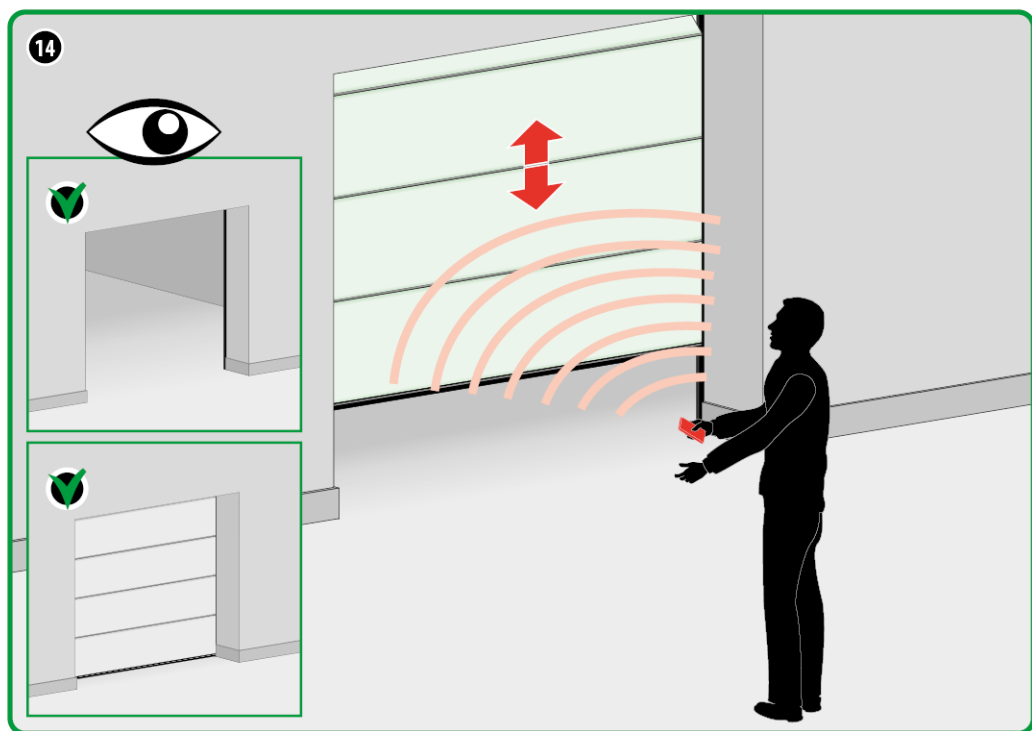

16

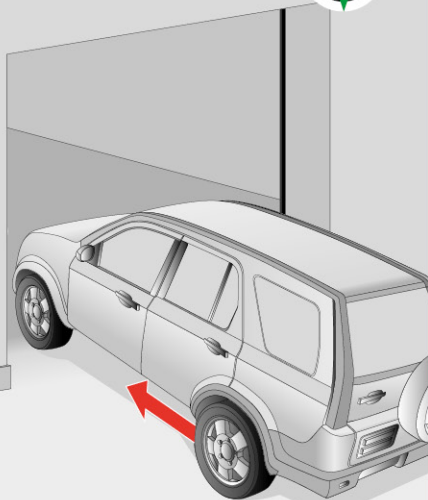
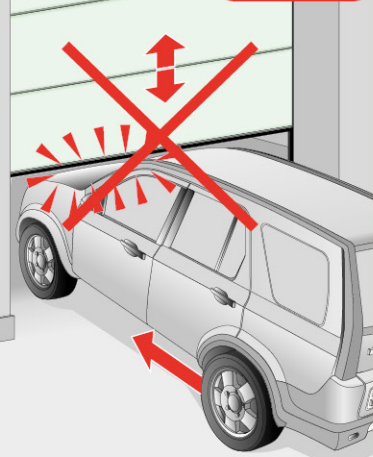
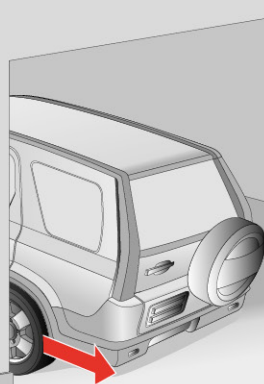
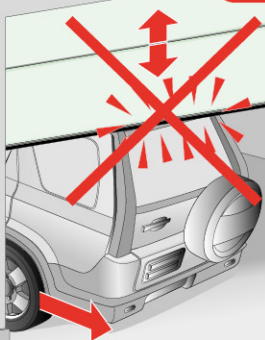

Installation and use of sectional doors must be carried out in accordance with the fitting instructions and user manual. Safety of use depends on the implementation of all actions specified in the fitting instructions and the use of sectional doors in accordance with all points specified in the user manual.

Using the sectional doors in violation of the manual is strictly forbidden as it may cause a serious accident, it voids the warranty and makes the manufacturer no longer liable for the product. Installation of the sectional garage door should be carried out by a person with appropriate qualifications. An error in the installation process may cause an uncontrolled movement of the sectional door and an injury to persons (or damage to property) situated in the area of its operation. The sectional door should be fitted by means of appropriate connection elements intended for a particular foundation type (concrete, wood, bricks, hollow bricks, steel profiles, etc.) **(1)**. Connection elements supplied with the sectional door are universal and not suitable for all foundation types. Do not use the sectional door until all installation operations have been completed. Caution! The sectional door should be installed once all finishing works are completed **(4)** and when the humidity level in the building reaches the proper value for dry rooms **(2)**. The interior of the garage should be completely finished before proceeding to installation (plastered, painted, with a finished floor, etc.) – do not attempt to install the sectional door when the garage is in the construction stage **(4)**. Walls and the garage opening should be even and perfectly level **(4)**. Any irregularities may impair the quality of the door's performance and its functional properties. Remove a protective foil of the panel immediately after the garage door has been installed **(5)**. Caution! Do not carry out any service, adjustment or repair works on elements that provide protection against the breakage of springs, cords and torsion springs. Any of the activities listed above can be carried out only by a suitably qualified person or a specialised service centre. Keep in mind that protection against the breakage of springs, cords and spring drive unit carries very high forces and stresses, therefore incorrect action performed on these elements of the sectional door may lead to serious threat to life or property **(12)**. Do not cover, cover with paint or remove the data plate during installation and use as it is necessary for the manufacturer to identify the product **(3)**. Do not load the sectional door and any of its components with additional elements, no objects may be hung on them **(11)**. Do not suspend or mount on the ceiling any objects that may obstruct the opening of the door. Visual check of all door components should be done regularly. Do not use the sectional door in which screws or bolts are loose. All connections may become loose as a result of the operation, therefore the correctness of connections should be checked twice a year and, if required, tightened. Do not use a damaged or incomplete garage door (e.g. frayed steel cord, cord incorrectly wound on the winding reel, roll fell out from the rail guide, sharp opening or closing of the door, vibration during door operation) until all defects have been removed. Contact the manufacturer in the event of missing elements of the door. It is forbidden to use spare parts other than original and recommended by the manufacturer. Periodical inspection of the door by qualified service personnel should be carried out. Do not install, repair, convert or adjust the electric drive of the door on your own as it may cause electric shock. Ensure adequate ventilation of the garage to prevent excessive accumulation of moisture inside when operating the sectional door **(13)**. It is strictly forbidden to stay or move within the operating area of the sectional door during its operation **(16)**. Caution! During the operation of the door, a person controlling it must have permanent eye contact with the moving sectional door **(14)**. For manual operation of the sectional door, use only handles, knobs and holders that are intended for this purpose. Pushing, pulling or grasping other parts of the door may cause an accident. Only one person can use the sectional door at a time. Children and people with physical and mental disabilities are not allowed to use the sectional door without adult supervision **(15)**. Children are not allowed to play in the operating area of the door, play with the garage door or its radio control **(11)(15)**. It is strictly forbidden to use the sectional door under the influence of alcohol or drugs. Movable elements of the sectional door must be lubricated at least once a year **(6)**. Do not use any dense lubricants that may affect the quality of the door operation. All elements of the sectional door should be cleaned cyclically with a dry or damp cloth without detergents **(7)(8)**. Do not use any caustic chemicals on the surface of the door and its components **(7)(8)**. Do not use sharp or hard tools to clean the door **(7)(8)**. In the event of repair, adjustment or maintenance, use personal protective equipment and protective clothing (glasses, gloves). Bending of panels due to temperature differences outside and inside the garage is a completely natural process and is not covered by the warranty. Before using the electric drive, read carefully its user manual. All instructions and documents provided with the garage door should be kept. Do not throw them away. Disposal of the worn sectional door should be carried out in accordance with local laws regarding the disposal of materials. The manufacturer does not bear any responsibility for damages in which people have suffered, damages to buildings or their elements which are the result of changes and interference in the product design. The manufacturer reserves the right to make changes and improvements without prior notice. If the instructions are unclear, contact your door supplier.